

MINI PLANT BALL VALVE

TYPE 300 P, ¼", PN 63

with spring close unit TYPE 43

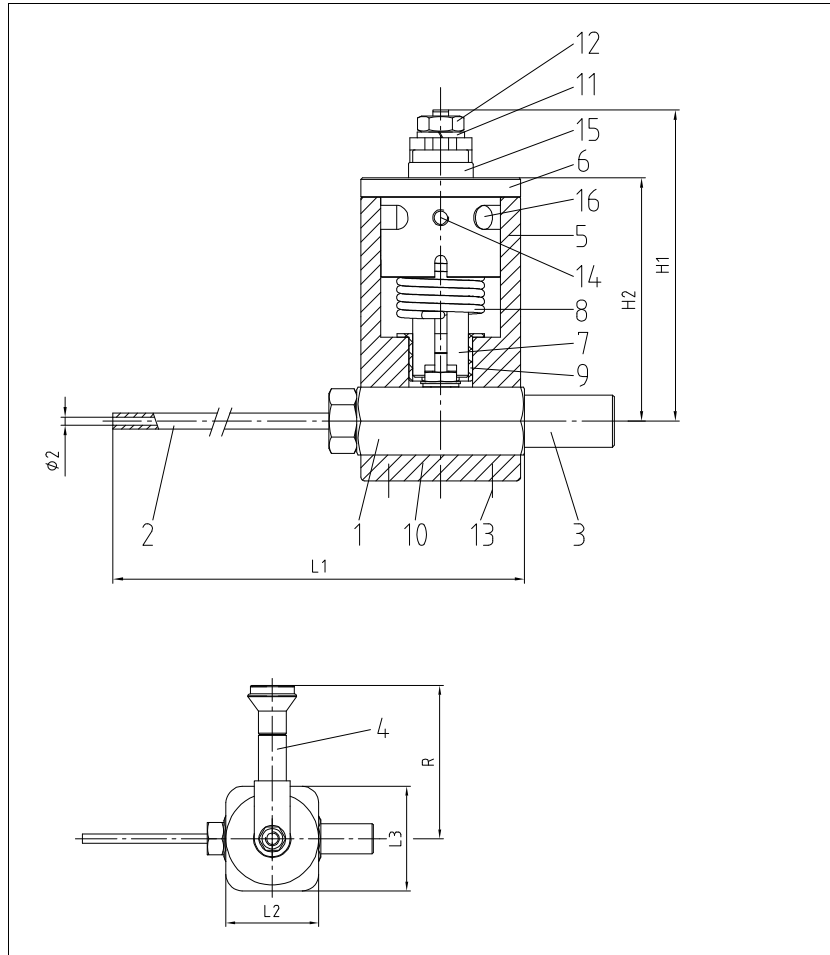

Mini plant ball valve
female threaded ends acc. to
EN 10226-1 with
screwed butt end connection
sampling tube with 2mm inside diameter
face to face dimensions acc. to
producers standard

Specification:

One-piece sampling device ball valve,
female threaded ends acc. to EN 10226-1
with screwed butt weld end connection,
sampling tube with 2mm inside diameter,
blow-out-proof-stem, body material
stainless steel (1.4408), free of non ferrous
metals, with spring close unit to avoid
wrong operation (open/close) by user.

Marking: TYP 300 P

Type: TYP 300 P-1.4408

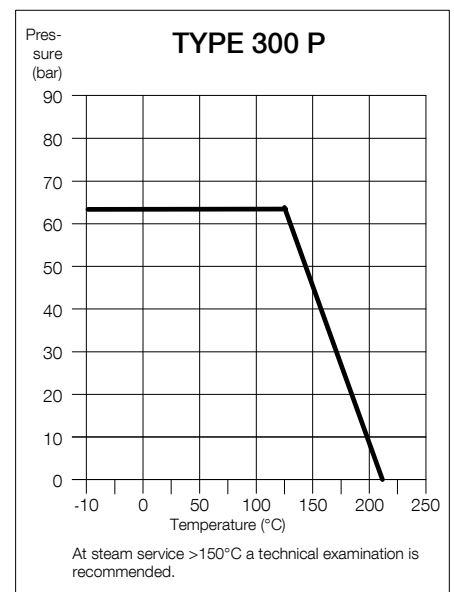

No.	Part	Material
1	ball valve	1.4408
2	sampling tube	1.4571
3	screwed butt weld end connection	1.4571
4	lever with grid unit	1.4301
5	housing upper part	1.4408
6	cap	1.4408
7	spindle	1.4305
8	spring	1.4310
9	bearing sleeve	EP
10	housing lower part	1.4408
11	spring washer	1.4310
12	hex. nut	A2
13	socked screw	A2
14	rounded head screw	A2
15	bearing	EP
16	pin	1.4305

Dimensions

DN	dimensions (mm)					
	L1	L2	L3	H1	H2	R
¼"	150	40	45	80	62	64

Ordering example:
TYPE 300 P, ¼", PN 63, 1.4408
with spring close unit TYPE 43